



UNDER THE AUTHORITY OF THE PLANNING ACT NOTICE OF PUBLIC HEARING

**By-Law No. 01-2026, being an amendment to Development Plan By-Law No. 05-2020, and
By-Law No. 02-2026, being an amendment to Zoning By-Law No. 13-2023**

The Rural Municipality of Ste. Anne, under the authority of *The Planning Act*, will hold a PUBLIC HEARING at the Municipal Office Council Chambers at the address shown above on **Wednesday, June 10, 2026**, at **10:00 am** in respect to the following matter:

General Intent:

1. To re-designate the land generally described as Pt. of W1/2-5-7-7-E Being Pt. Lot 2, Plan 68088 WLTO, as shown on the map below, from Agricultural Mixed-Use Areas to Rural Residential Area.

2. To rezone the land generally described as Pt. of W1/2-5-7-7-E Being Pt. Lot 2, Plan 68088 WLTO, as shown on the map below, from Agricultural Mixed-Use Zone to Rural Residential Zone.

Area:

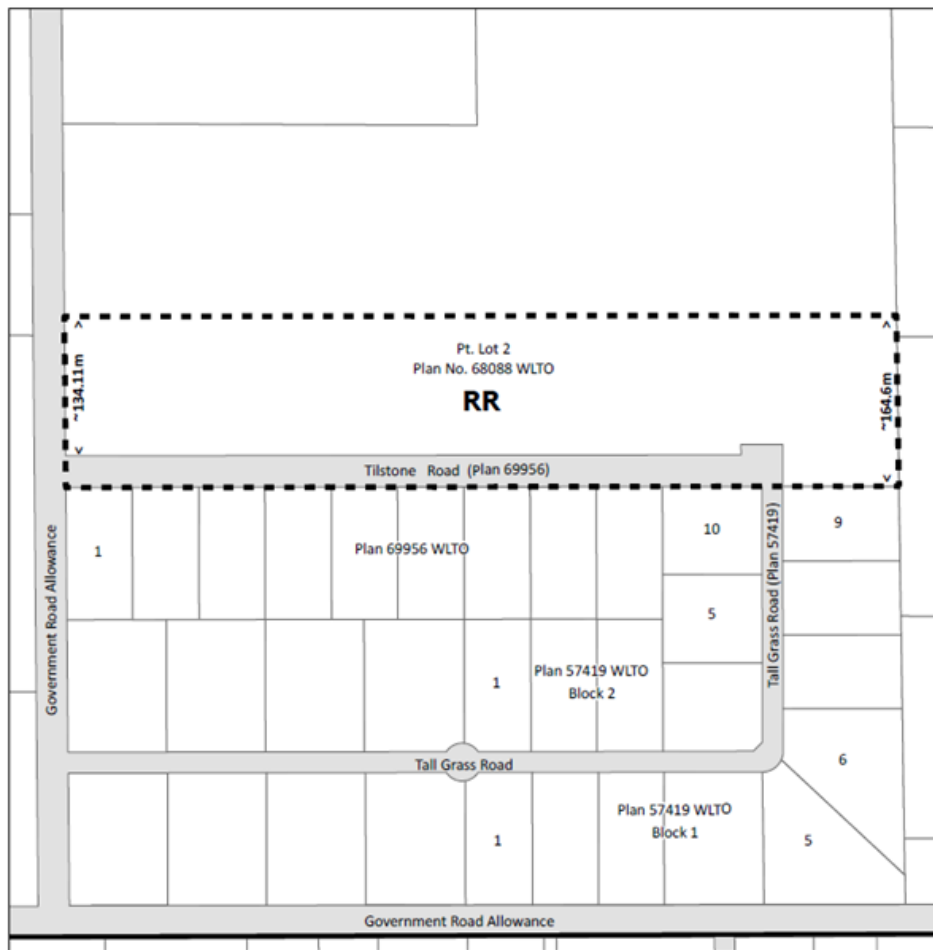

FOR INFORMATION CONTACT: Hadiseh Bajelan, M.C.P, M.Arch, Development Officer
E: development@rmofsteanne.com P: 204-422-5929 ext.107



REPRESENTATION OPTIONS:

Council will hear any person who wishes to make representation, ask questions or register an objection regarding this application. Individuals who plan to make a representation can do so by:

- Submit a written representation by email, mail, or fax to the contact information listed above; or
- Attend the public hearing in person or virtually. Individuals making a presentation are requested to limit their remarks to five (5) minutes. Those wishing to attend virtually must email development@rmofsteanne.com no later than Tuesday, June 9, 2026, at 12:00 p.m. to receive the meeting link and participation instructions.

Note: All written submissions will be presented to the Council and will become public information. Submissions will be read aloud during the hearing, along with the name and civic address of the person submitting. Please note that anonymous submissions cannot be accepted.

A copy of the documents related to the matter to be considered at the hearing may be inspected at the municipal office during normal office hours, 8:30 am – 4:30 pm, Mon. to Fri. Documents can be provided in alternate formats upon request.